

X-Station 2

Versatile Intelligent Terminal



Suprema X-Station 2 is a versatile intelligent terminal that supports Mobile Access, RFID cards as well as QR codes, offering the ultimate flexibility in terms of credential options and system design.



suprema
SECURITY & BIOMETRICS

X-Station 2

Versatile Intelligent Terminal

Benefits at a glance



Multi-technology Terminal with Various Credential Options

- Multiple credential options of RFID cards, Mobile Access and QR codes offer maximum system design flexibility
- Go mobile, card-less and carefree by using smartphones as credentials



Comprehensive RFID Card Compatibility

- LF(125kHz), HF(13.56MHz) dual-band
- Reads various card types (EM/MIFARE/iCLASS/DESFire/FeliCa)



Enhanced Security and Data Protection

- Protects data with secure boot process
- Built-in camera captures image logs for added security
- Open Supervised Device Protocol (OSDP) for secure bidirectional communication between the terminal and controller
- Built on Android and all it security enhancements



Designed for easy deployment and management

- Power over Ethernet(PoE) enables convenient installation with less wiring
- Dust-tight and waterproof IP65 protection



Improved Usability of Android UI on Touchscreen

- Quick and easy access to features on 4" wide capacitive touchscreen
- Customizable display on intuitive Android GUI



Expanded Capacity for more users and security logs

- Max. 500k users, 5 million text logs, 50k image logs
- Large memory: 16GB Flash + 1GB RAM

Specifications

Model Name	XS2-DPB	XS2-QDPB	XS2-APB	XS2-QAPB
RF Option	125kHz EM & 13.56MHz MIFARE, MIFARE Plus, DESFire EV1/EV2*, FeliCa		125kHz EM, HID Prox & 13.56MHz MIFARE, MIFARE Plus, DESFire EV1/EV2*, FeliCa, iCLASS SE/SR/Seos	
Mobile Card	NFC, BLE			
QR/Barcode	N/A	Supported	N/A	Supported
CPU	1.5 GHz Quad Core			
Memory	16GB Flash + 1GB RAM			
Max. User	500,000			
Max. Logs	Text 5,000,000 / Image 50,000			
LCD	4" IPS color LCD / 480 x 800 pixels			
Camera	CMOS 2M pixels / 1600 x 1200			
Ethernet	Supported (10/100 Mbps, auto MDI/MDI-X)			
RS-485	1ch Host or Slave (Selectable)			
Wiegand	1ch Input or Output (Selectable)			
TTL	2ch Inputs			
Relay	1 Relay			
PoE	Supported (IEEE 802.3af compliant)			
IP rating	IP65			
Tamper	Supported			
Power	DC 12V (Max. 0.8A) or DC 24V (Max. 0.45A)			
Dimensions (WxHxD, mm)	82 mm x 159 mm x 27.2 mm	82 mm x 203 mm x 35.2 mm	82 mm x 159 mm x 27.2 mm	82 mm x 203 mm x 35.2 mm
Operating temperature	-20°C ~ 50°C			
Certificates	KC, CE, FCC (Compliance: RoHS, REACH, WEEE)			

* DESFire EV2 cards are supported by having backward compatibility of DESFire EV1 cards. CSN and smart card functions are compatible with X-Station 2.

System Configurations

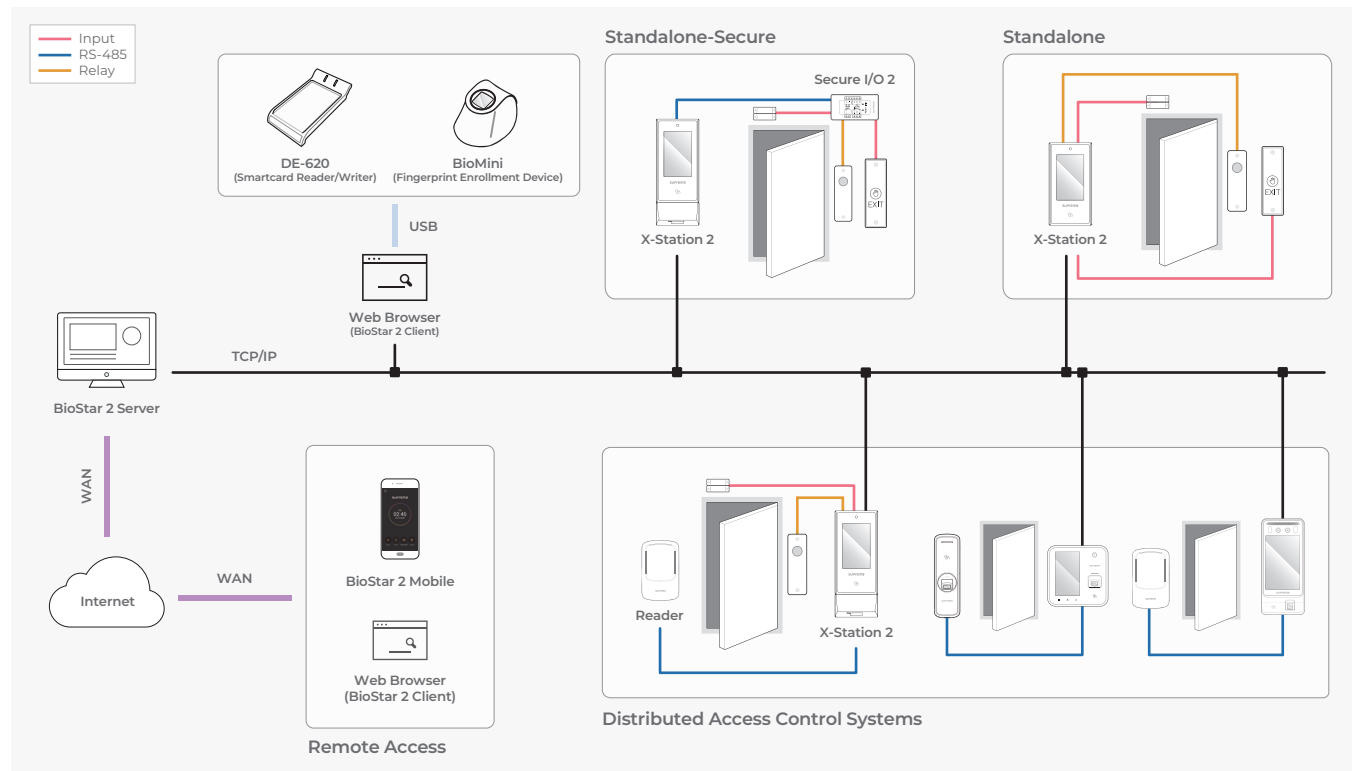

suprema
SECURITY & BIOMETRICS

Suprema Inc.

17F Parkview Tower, 248, Jeongjail-ro, Bundang-gu, Seongnam-si, Gyeonggi-do, 13554, Republic of Korea
T +82 31 783 4502 E sales_sys@supremainc.com www.supremainc.com



For more information about Suprema's global offices, visit the webpage below by scanning the QR code.
<https://www.supremainc.com/en/about/contact-us.asp>